

1.15 AMP SOCKET	UPS POINT	DATA POINT	ROSE	15
COMPUTER POINT	15 AMP TBN & R	25 LIGHT SWITCH	ROSE OR SHAW SPEAKER	15
TELEPHONE POINT	32 AMP TBN & R	30 DIMMER LIGHT SWITCH	MIC	15
			30 SOUND CONTROL POINT	15
				15

**DISCLAIMER:**  
This drawing is supplied for information only. It is subject to review and approval by the Project Architect and/or other members of the Design Team.

**NOTES:**  
All dimensions & facilities to be verified on site.  
Drawn in Acad 2000 saved as a Acad 14 file. Model space drawing scale 1:1. Paper space NTS.

PRE-ASSEMBLY AREA

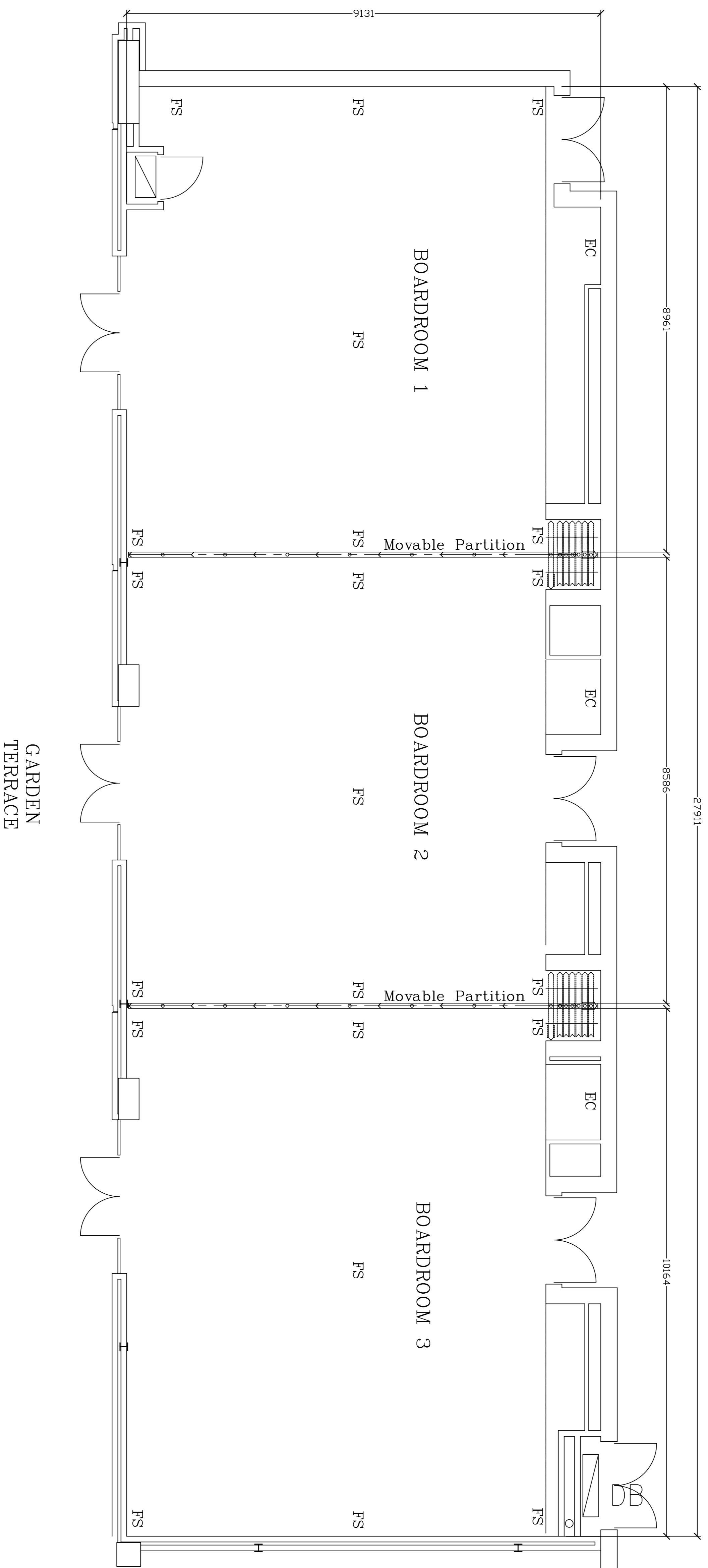

FS = Floor Socket consisting of:  
 EC = Equipment cupboard consisting of:  
 UPS UPS UPS UPS  
 UPS UPS UPS UPS

Project: SANDTON CONVENTION CENTRE	
Title: LEVEL 2 BOARDROOMS 1, 2 & 3	
Date: 24/4/01	Revision: -
Dwg: SCC-016	Scale: NTS